



GPE.
Fully Managed

thirtyonealfredplace.co.uk

Thirty One Alfred Place

A WORKPLACE EMBRACING EVERYDAY WELLNESS

31-34 Alfred Place,
Fitzrovia, WC1E 7DP

Contents

04	What's in your building	>
06	Why us	>
10	Working towards a better world	>
11	Schedule of areas	>
19	Floorplans	>
24	Location	>
29	Get in touch	>



Welcome to Thirty One Alfred Place, where your wellbeing is our priority

Set in the heart of the lively and historic neighbourhood of Fitzrovia, Alfred Place is steeped in history. We have unlocked its potential as a stunning modern workspace, designed with wellness in mind.

Every detail has been carefully considered to create Fully Managed workspaces where businesses – and your people – can thrive. The quality of materials and finish can be seen in every corner of Thirty One Alfred Place, as can our commitment to celebrating the best in sustainable practices.

Echoing the award-winning Alfred Place Gardens that sit on the building's doorstep, Thirty One Alfred Place offers a tranquil haven away from the hustle and bustle of Tottenham Court Road.

42,000 sq ft

8 Floors

Workspaces ranging from
700– 5,400 sq ft

Providing an array of office spaces tailored for **10 to 80** desks, each with exclusive on-floor amenities and thoughtfully designed shared areas.





Key features



Communal roof terrace



Spacious shared lounge



Self serve coffee bar



Flexible wellness space



Event space



Multiple breakout areas



Shared meeting room suite



Private terraces on selected floors



Customer experience team



Phone booths



Changing rooms, lockers & showers



Bike storage

Make yourself at home

For businesses who prefer their offices to have a little personality, Thirty One Alfred Place is the place to be. Located right by charming Store Street, this characterful, contemporary space fits in seamlessly. With calming green gardens on your doorstep, Thirty One Alfred Place is created to provide the ultimate in work/life balance.



Exceptional wellness amenities

From our flexible wellness space and vibrant events programme, to our showers and bike storage, our amenities are curated to enhance your overall experience.



An impressive welcome

With an inviting communal reception area, relaxation spaces, and self serve coffee bar, you can start and end your day right.



Workspace delivered by experts

We love to create flexible and inspiring Fully Managed spaces. All our experience has gone into ensuring Thirty One Alfred Place will be perfect just for you.



High-quality floors

Refurbished with the best in sustainable materials, each floor has excellent natural light and is fully contained and customisable.



Central location

Just a stone's throw from Tottenham Court Road and Goodge Street stations, Thirty One Alfred Place offers multiple commuting options for your employees.



Communal roof terrace

One of the many features that gives Thirty One Alfred Place the WOW factor. A shared roof terrace to relax, socialise, enjoy the fresh air and have lots of fun.



Outdoor roof terrace



Spacious shared lounge



Meeting room suite



Space to relax

What's in your building

It's all included in one bill, no hidden extras



6 reasons to choose GPE Fully Managed



1 – Fully managed and fully yours

Say hello to a furnished workspace that's exclusively yours. Our Fully Managed service is a truly hassle-free experience.

[How we make it hassle-free](#)



2 – All-in-one bill with no hidden extras

Say goodbye to multiple bills. Each month you'll receive one all-inclusive bill from us, and, your bill remains fixed for your contract period.

[See what's included](#)



3 – Relax, you're in safe hands

We've been doing this for a long time. Our in-house experts curate the perfect experience, so you can enjoy market-leading workspaces. We own and manage our buildings, so you'll always deal directly with us.

[Learn more about us](#)



4 – Plug in and go – your tech's all sorted

You get safe, secure and fast wireless connectivity so you can work seamlessly from day one, with IT help on-hand. Everyone gets access to sesame™, your workspace app.

[Head over to the tech](#)



5 – Working towards a better world

We're committed to becoming a net zero carbon business by 2040, sourcing 100% renewable energy and maximising material reuse. We'll also work with you to reduce your carbon footprint, creating sustainable spaces where your business can thrive.

[How we're reducing our impact](#)



6 – Exceptional service as standard

Your people are our priority. It's why we've developed our customer charter – the values by which we operate – so we can deliver you a great experience.

[Learn more about our services](#)

Exceptional service as standard



Everything taken care of

Our welcoming customer management team will ensure a hassle-free experience for you and your employees. Let our team take care of everything so you can focus on running your business.



Building management



Community management



Statutory compliance



Food & Beverage



24/7 Helpdesk



Health & safety



Maintenance



Access & visitor management



Events

Purposeful partnerships

We're passionate about working closely with our thriving local communities, supporting local businesses and social enterprises. By choosing a Fully Managed workspace, you help these fantastic businesses every day.



Our events and wellness programme

Our workplaces are more than just offices—they're vibrant communities that foster genuine connections.

Your Customer Experience Manager will help keep your team happy and engaged with a thoughtfully curated programme of wellbeing initiatives and events throughout the year.

From wellness sessions to networking opportunities, seasonal celebrations, charitable fundraisers and educational workshops, we create experiences that bring people together and make the workplace an inspiring and happy place to be.



Networking events



Fitness classes, yoga & pilates



Creative workshops



Seasonal pop-ups



Screening of sporting events



Charitable fundraisers

[Contents](#)

Thirty One Alfred Place

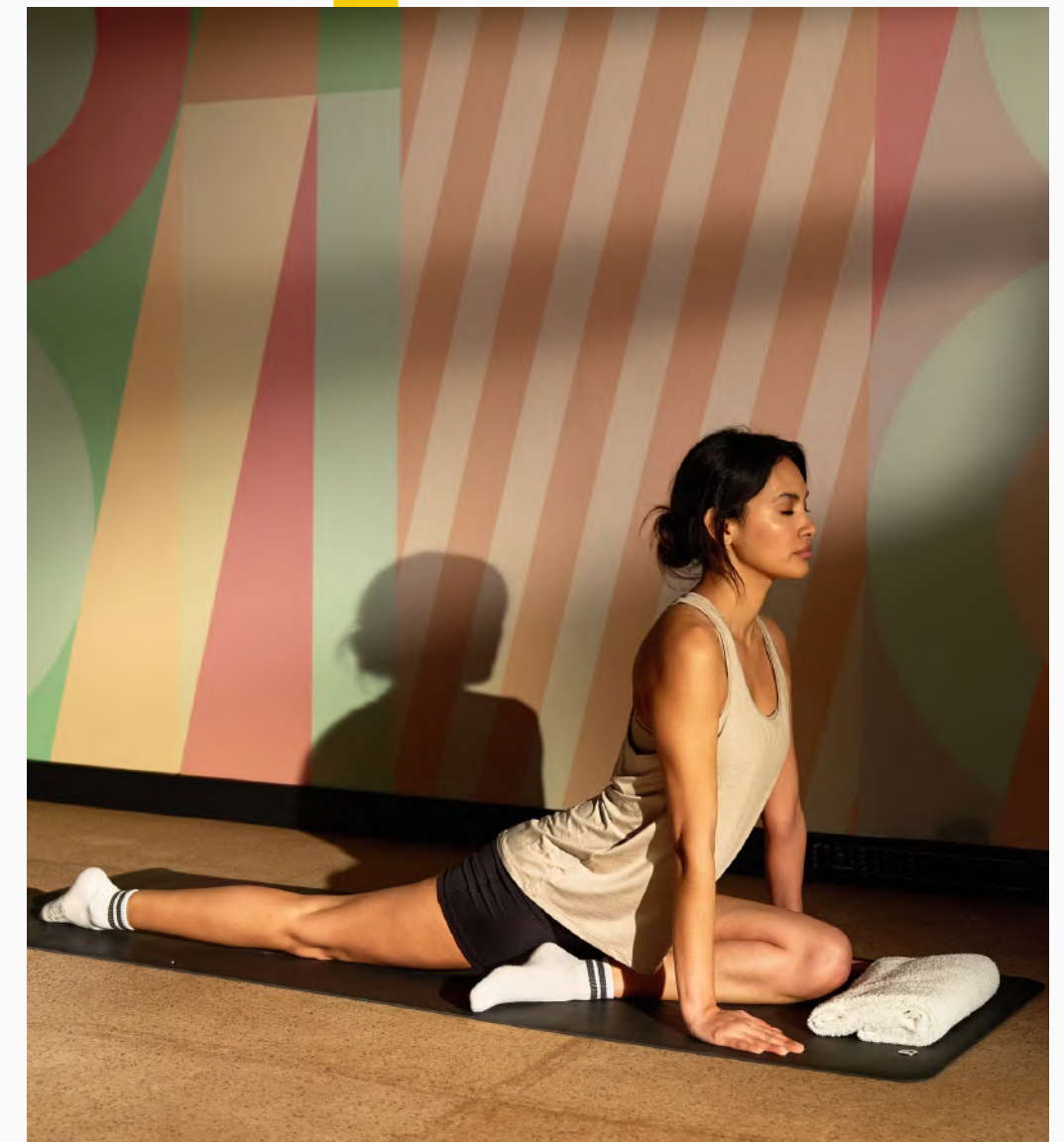

*Event programme is subject to change and will vary by building.

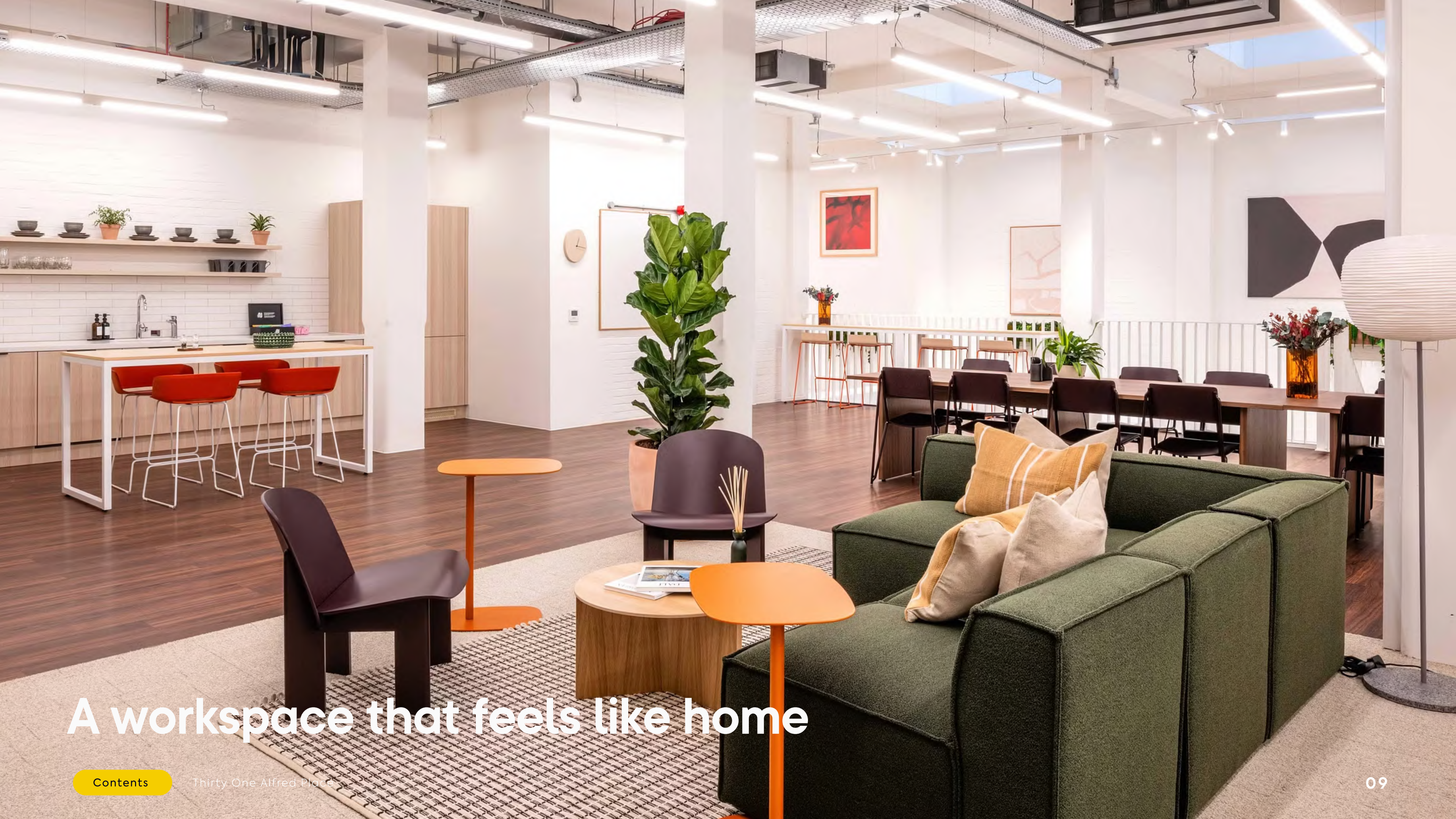

A workspace that feels like home

Sustainability is at the core of everything we do.

We are creating workspaces that prioritise the environment, community and wellbeing of your team.

Our commitment at Alfred Place:



Sustainable refurbishment and fit-out. Targeting SKA Silver.



Energy efficiency EPC B rating.



100% electric building.



Improved biodiversity.



Adding social value through local community initiatives.



At GPE, we are:



Integrating climate resilience across our business.

- Creating more green space.
- Creating adaptable, future-proof buildings.



Decarbonising our business to become net zero by 2040.

- Using 100% renewable energy.
- Low carbon by design, including using preloved materials and furniture.



Putting health and wellbeing front and centre.

- Fitwell/WELL enabled buildings and air quality monitoring.
- Creating inclusive spaces and running wellbeing events.



Creating a lasting positive social impact in our communities.

- Supporting social enterprises and charities.
- Supporting local employment and apprenticeships.

Schedule of areas

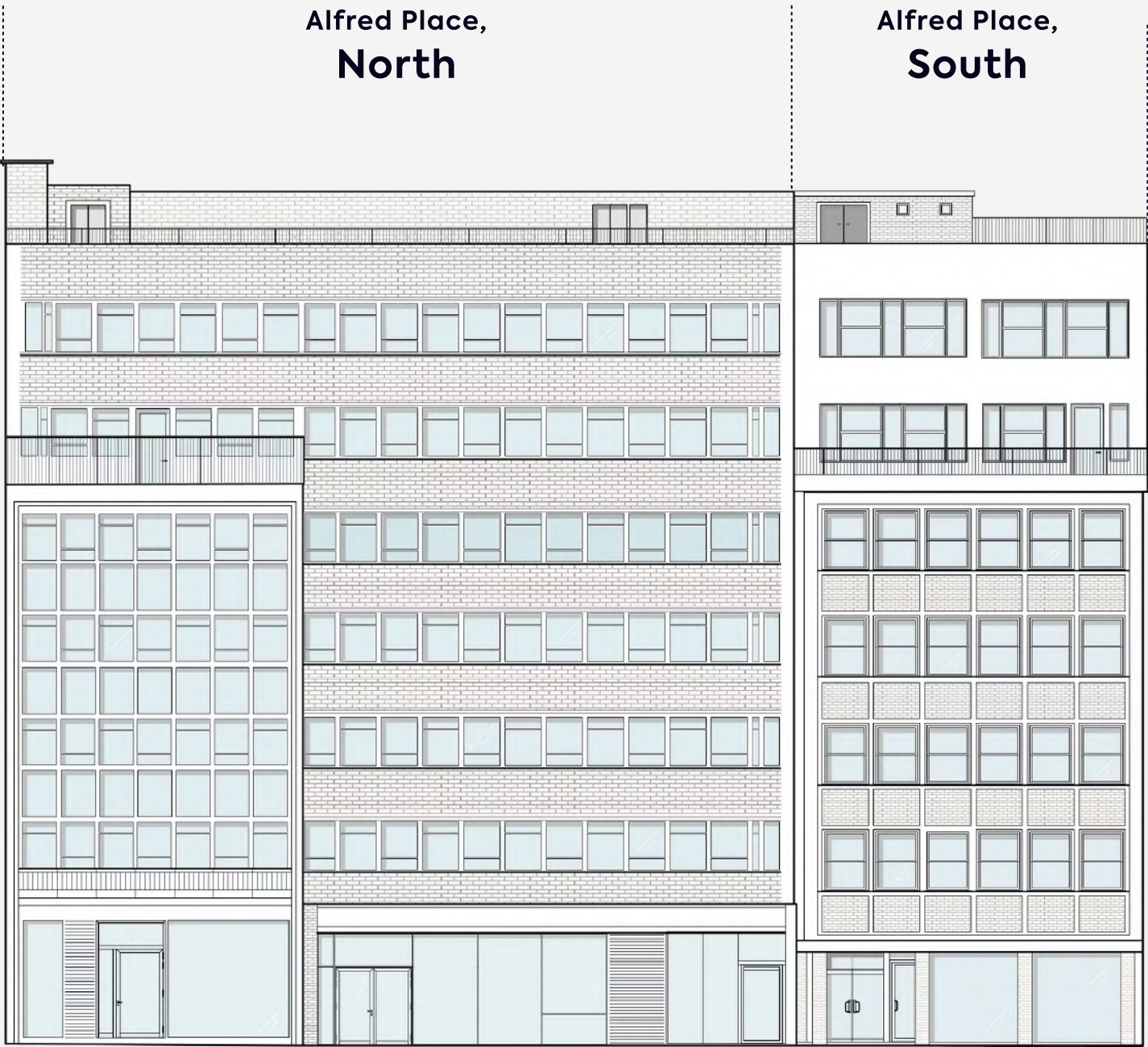

	<div><div></div>FULLY LET</div> <div>North</div>				<div><div></div>AVAILABLE</div> <div>South</div>		
FLOOR	SQFT	DESKS		SQFT	DESKS	FEATURES	
7th floor	Amenity space		>	Amenity space		>	Communal outdoor terrace
6th floor	2,172	30	>	932	12	>	Office space
5th floor	2,171	28	>	749	10	>	Office space with private terrace
4th floor	2,434	36	>	2,427	38	>	Office space
3rd floor	2,433	36	>	2,422	32	>	Office space
2nd floor	2,437	36	>	2,422	34	>	Office space
1st floor	4,515	58	>	2,409	32	>	Office space
Duplex (G & LG)	5,476	60	>	-	-		Office space
Ground	-	-		719	12	>	Office space
Ground	Amenity space		>	Amenity space		>	Bike storage, shower and changing facilities
Lower Ground	Amenity space		>	Amenity space		>	Communal kitchen, meeting rooms and wellness studio
Lower Ground	1,225	18	>	2,740	28	>	Office space
TOTAL	22,863	302		14,820	197		



Modern amenities that make you more comfortable

Alfred Place

Ground floor

Communal space and end of trip amenities

A warm and welcoming reception and communal area with a self serve coffee bar, multiple breakout spaces, and phone booths. Bike storage and showers can also be found here.

- 

Reception area
- 

Coffee bar
- 

Shared lounge
- 

Breakout space
- 

Showers and changing rooms
- 

Bike storage

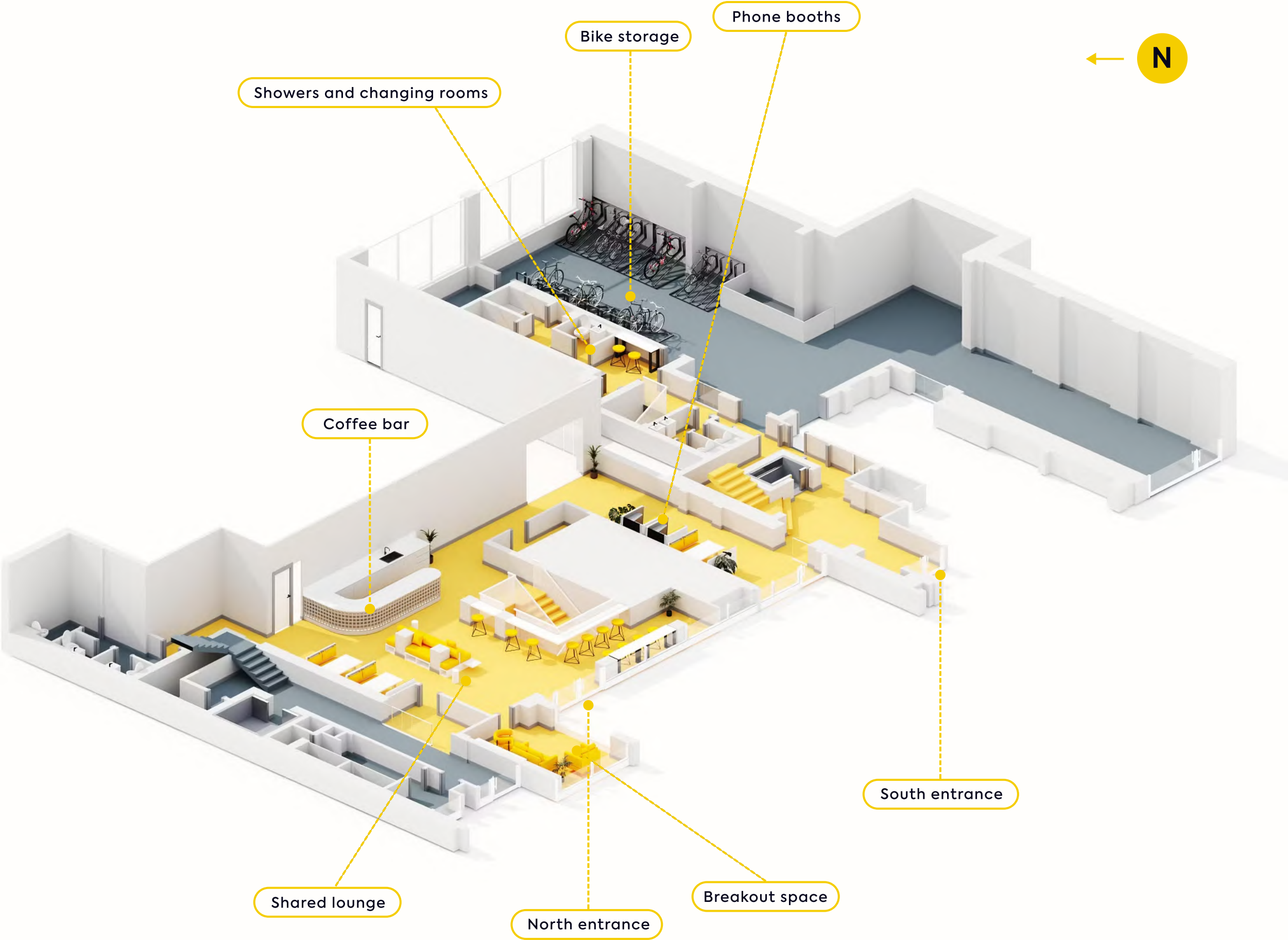







Relaxation spaces for a balanced workday

Alfred Place

Lower ground floor

Communal wellness space and meeting room suite

Contemporary meeting rooms and kitchen area as well as a flexible wellness, games and event space.

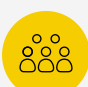
-  Meeting rooms
-  Shared teapoint
-  Wellness space
-  Breakout space
-  Event space

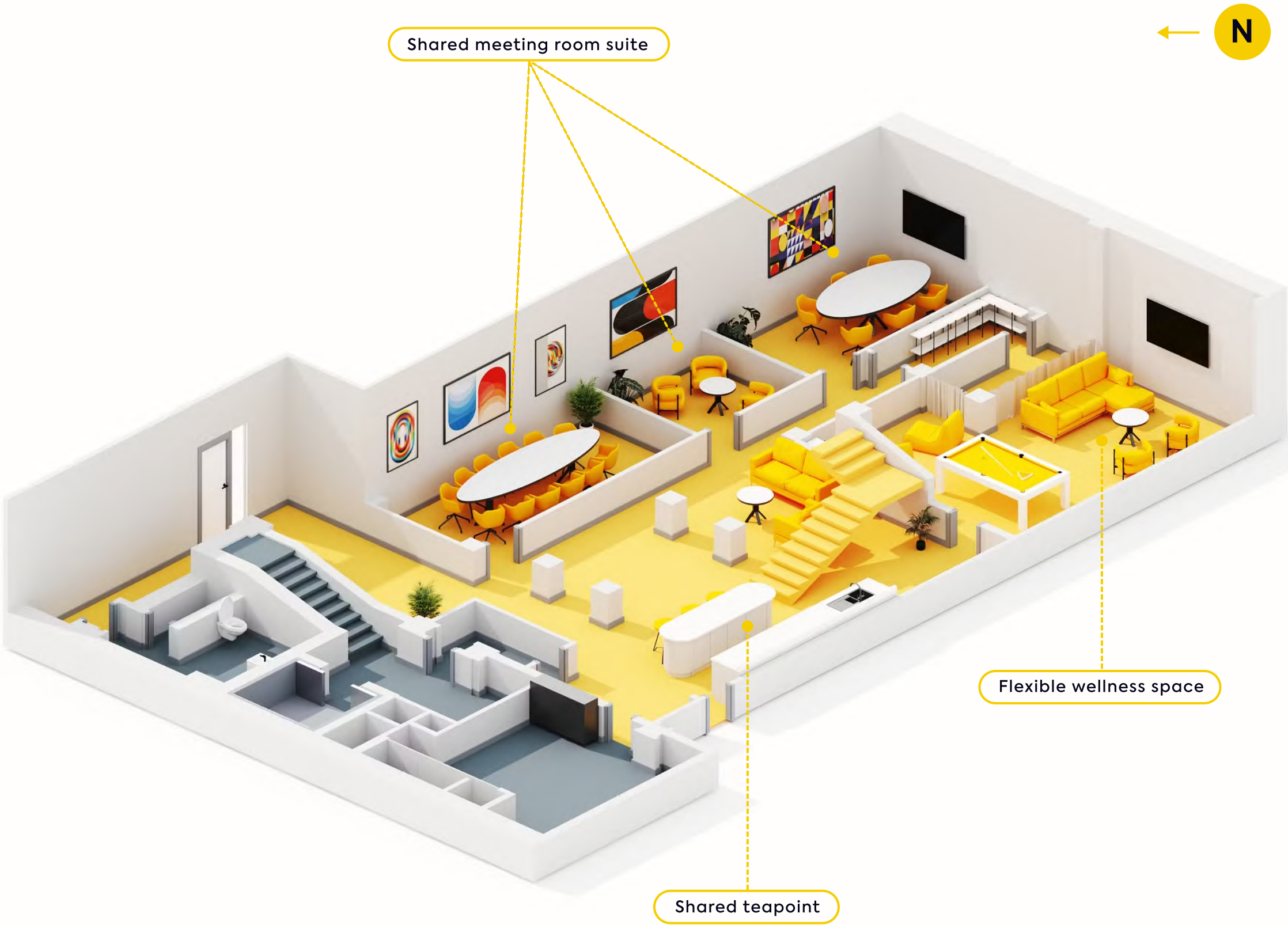
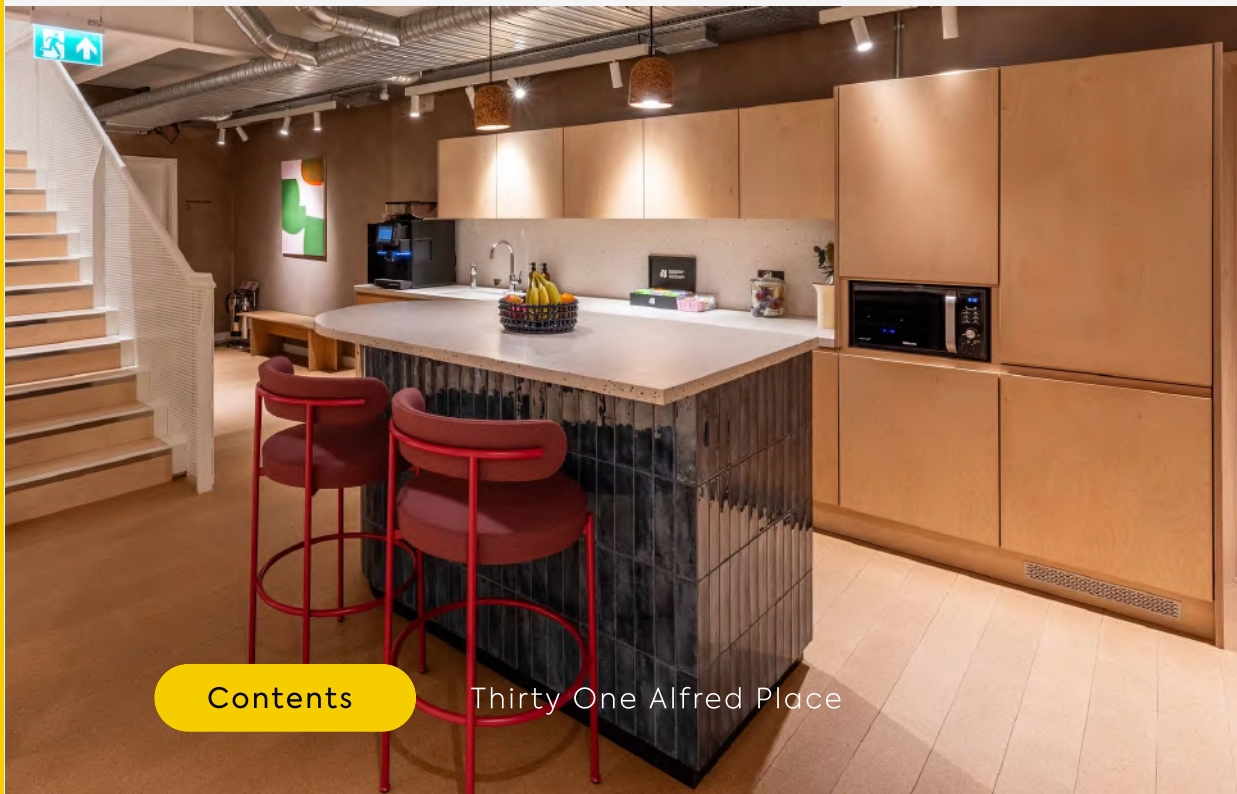

Where ideas come to life



Key features

Communal roof terrace	Spacious shared lounge	Self serve coffee bar
Flexible wellness space	Event space	Multiple breakout areas
Shared meeting room suite	Private terraces on selected floors	Customer experience team
Phone booths	Changing rooms, lockers & showers	Bike storage

04

Alfred Place

Roof terrace

Communal space

A beautiful plant-filled outdoor terrace and breakout space.

 Breakout space

 Outdoor space

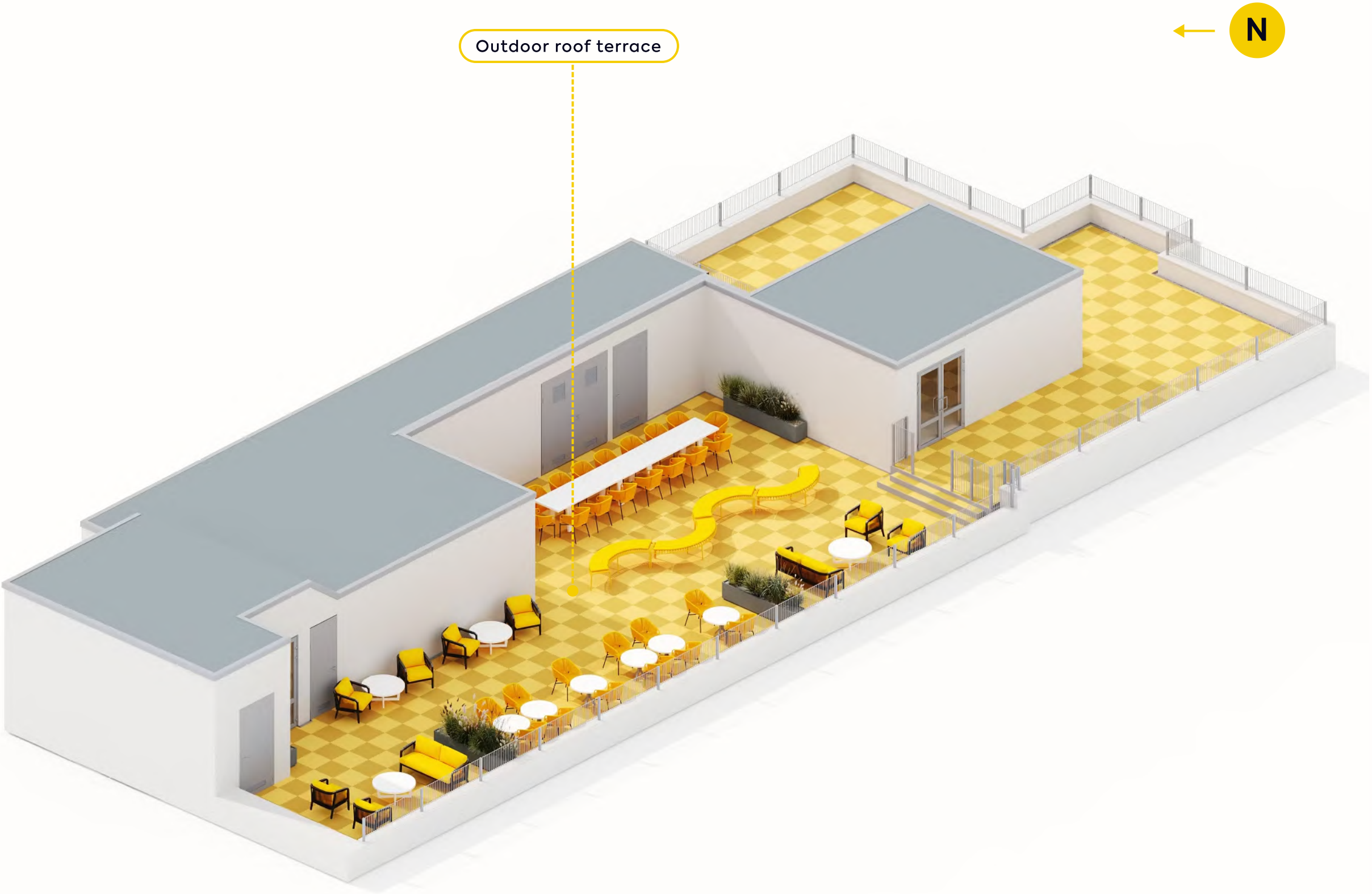
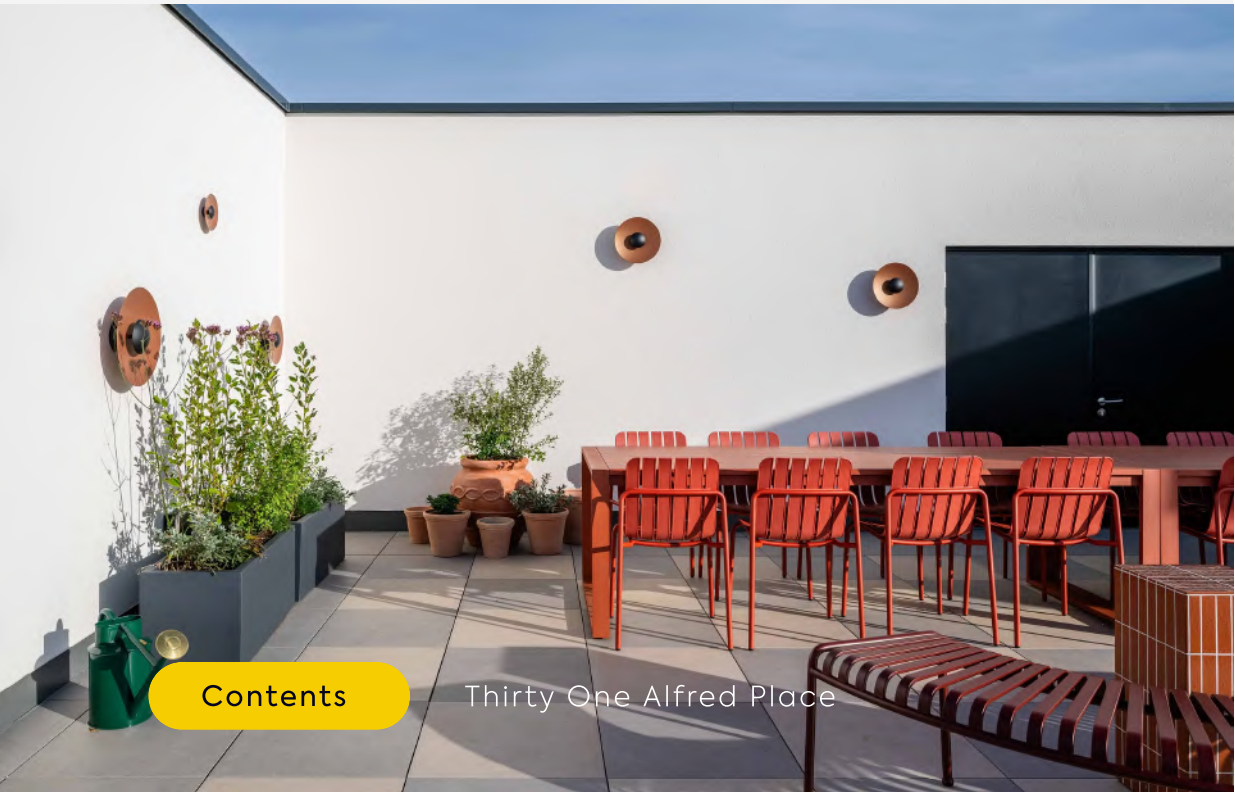

A rooftop terrace with a grey concrete wall on the left featuring several circular, copper-colored light fixtures. In the foreground, a long sofa with blue and white striped cushions is positioned. To the left of the sofa are several bright yellow armchairs and a large potted plant in a terracotta pot. In the background, there are wooden tables and chairs, more potted plants, and a view of a city skyline under a cloudy sky.

A stunning terrace,
because work should happen outdoors too

Floorplans

Thirty One Alfred Place, South



3rd Floor

Alfred Place, South



- 2,422 sq ft
- 32 current desks
- 38 maximum occupancy
- 2 meeting rooms
- Kitchen
- Breakout areas
- 1 phone booth
- Coffee machine



[View/download 2D floorplan](#)

6th Floor

Alfred Place, South



- 932 sq ft
- 12 current desks
- 15 maximum occupancy
- 1 meeting room
- Kitchen
- Breakout area
- 1 phone booth
- Coffee machine



[View/download 2D floorplan](#)

3rd Floor

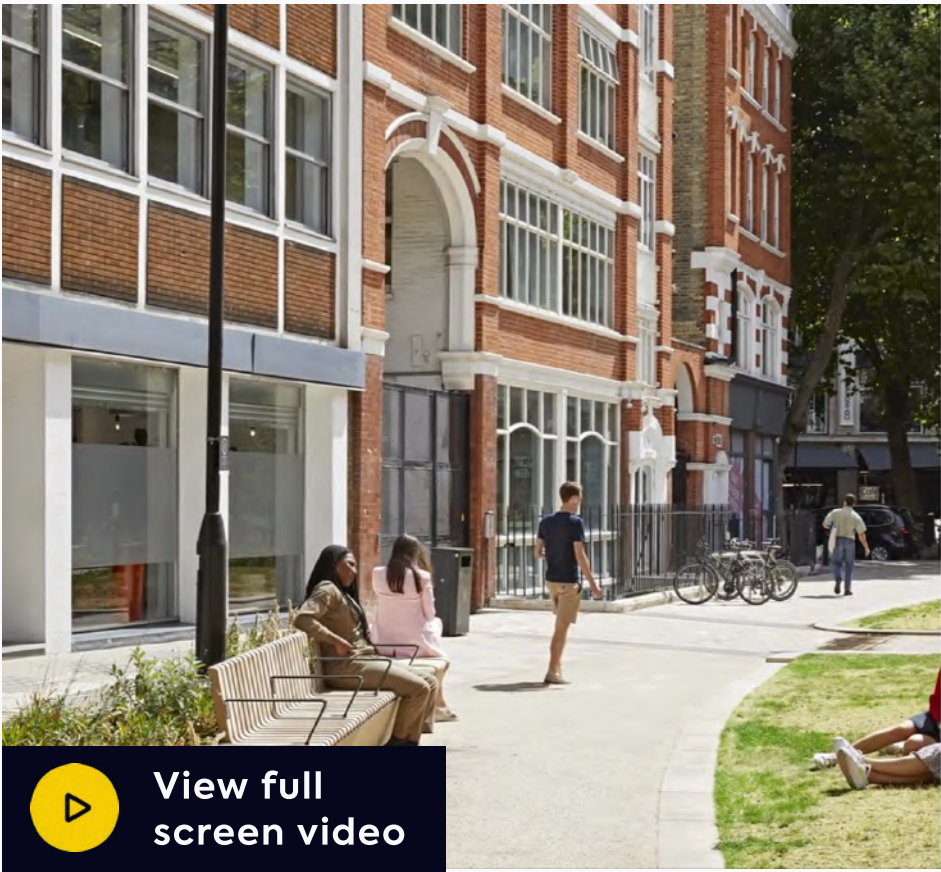
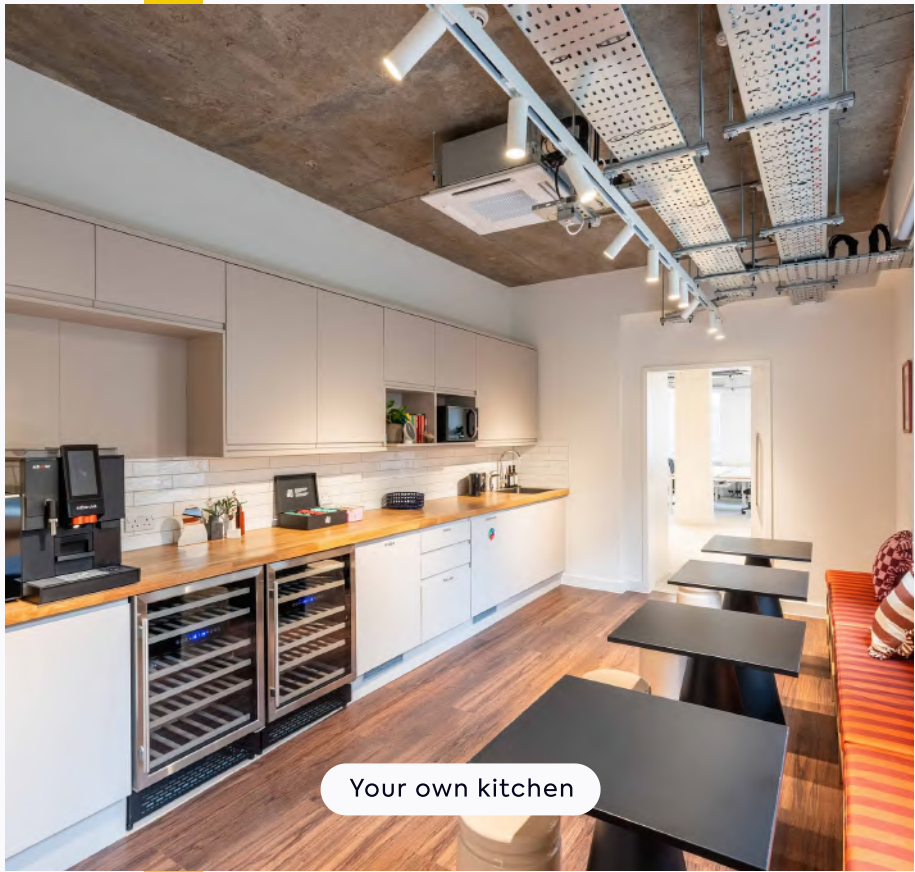

GPE.
Fully Managed



Thirty One Alfred Place

3rd Floor, South
33-34 Alfred Place,
Fitzrovia, WC1E 7DP



Truly Connected



Alfred Place is the perfect workplace for commuters, with Goodge Street, Tottenham Court Road and Warren Street stations, just a stones throw away. Staying connected has never been easier here at Alfie's.



Walking Distance

Goodge Street
2 mins



Tottenham Court Road
5 mins



Warren Street
9 mins



Russell Square
10 mins



Leicester Square
15 mins



Oxford Circus
15 mins



Great Portland Street
15 mins





Historic Bloomsbury



Caffè Tropea



L. Cornelissen & Son



Store Street

Relax



Arcade Foodhall

Taste



The British Museum



Macallaio

Tried and tasted

Within

10

minutes



Highlights

- 1 Black Sheep Coffee
- 2 Store Street Espresso
- 3 The Life Goddess
- 4 College Arms
- 5 Busaba Bloomsbury
- 6 Vagabond Charlotte Street
- 7 Charlotte Street Hotel
- 8 Bloomsbury Street Kitchen
- 9 Circolo Popolare
- 10 Arcade Foodhall



Our pick

Arcade Foodhall

With the vibrancy of the cuisine on offer matched by the liveliest of atmospheres, this global street food mecca is a must-visit.

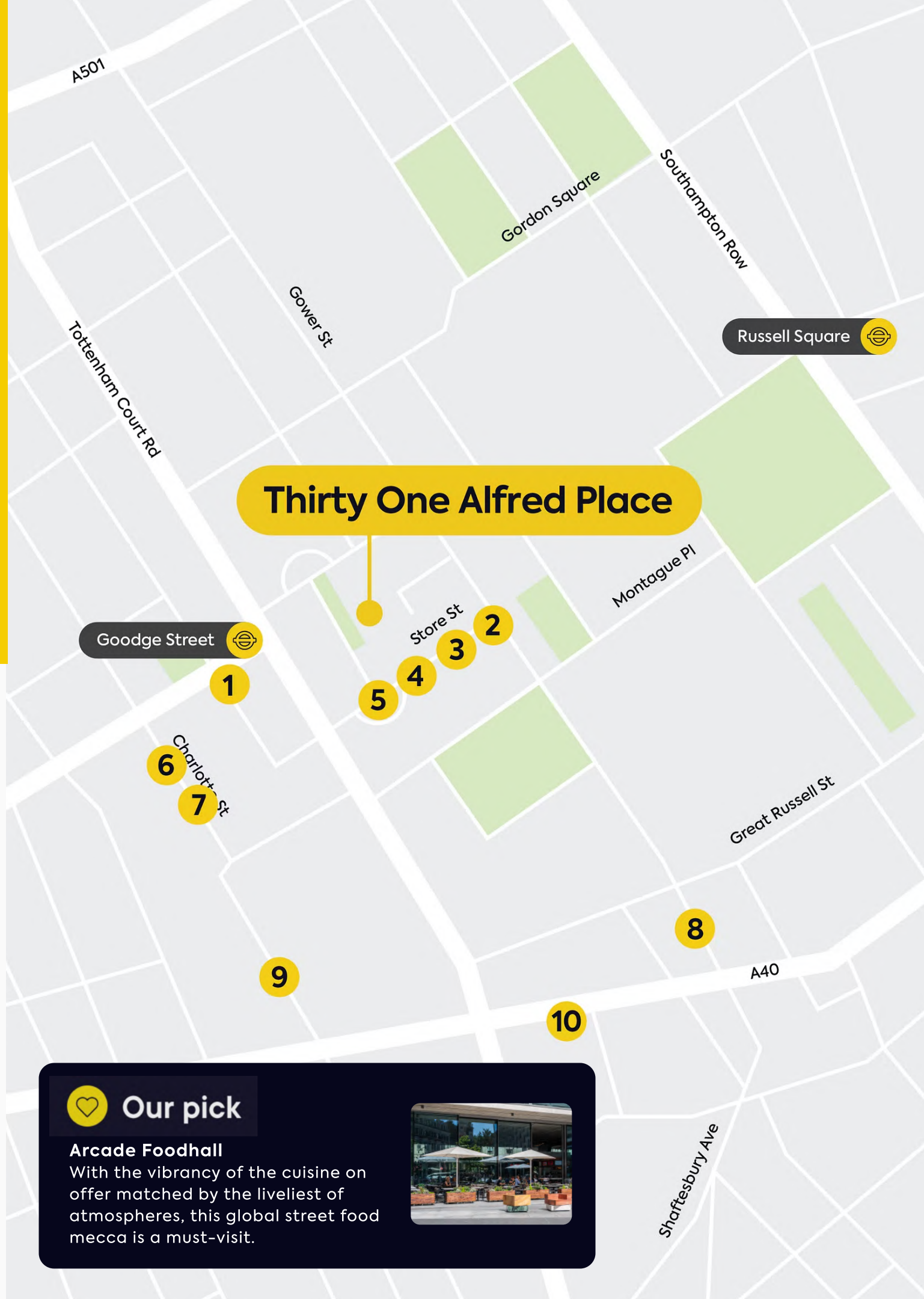

Good food



The Alfred Place dining scene is as diverse as it is colourful, with a wealth of choice to suit every taste.

Whether sipping an Americano from Black Sheep or enjoying a mouth-watering Greek dish at The Life Goddess on Store Street, you never have to stray far to satisfy your cravings.

Spoilt for choice

Within

10

minutes



Highlights

- 1 Brunswick centre
- 2 Russell Square
- 3 International Food Market
- 4 Heal's
- 5 Monopoly Life Sized
- 6 Mr Fogg's House of Botanicals
- 7 Odeon Tottenham Court Road
- 8 British Museum
- 9 Dominion Theatre
- 10 Flight Club Bloomsbury



Our pick

British Museum
Discover two million years of human history and culture just down the road,

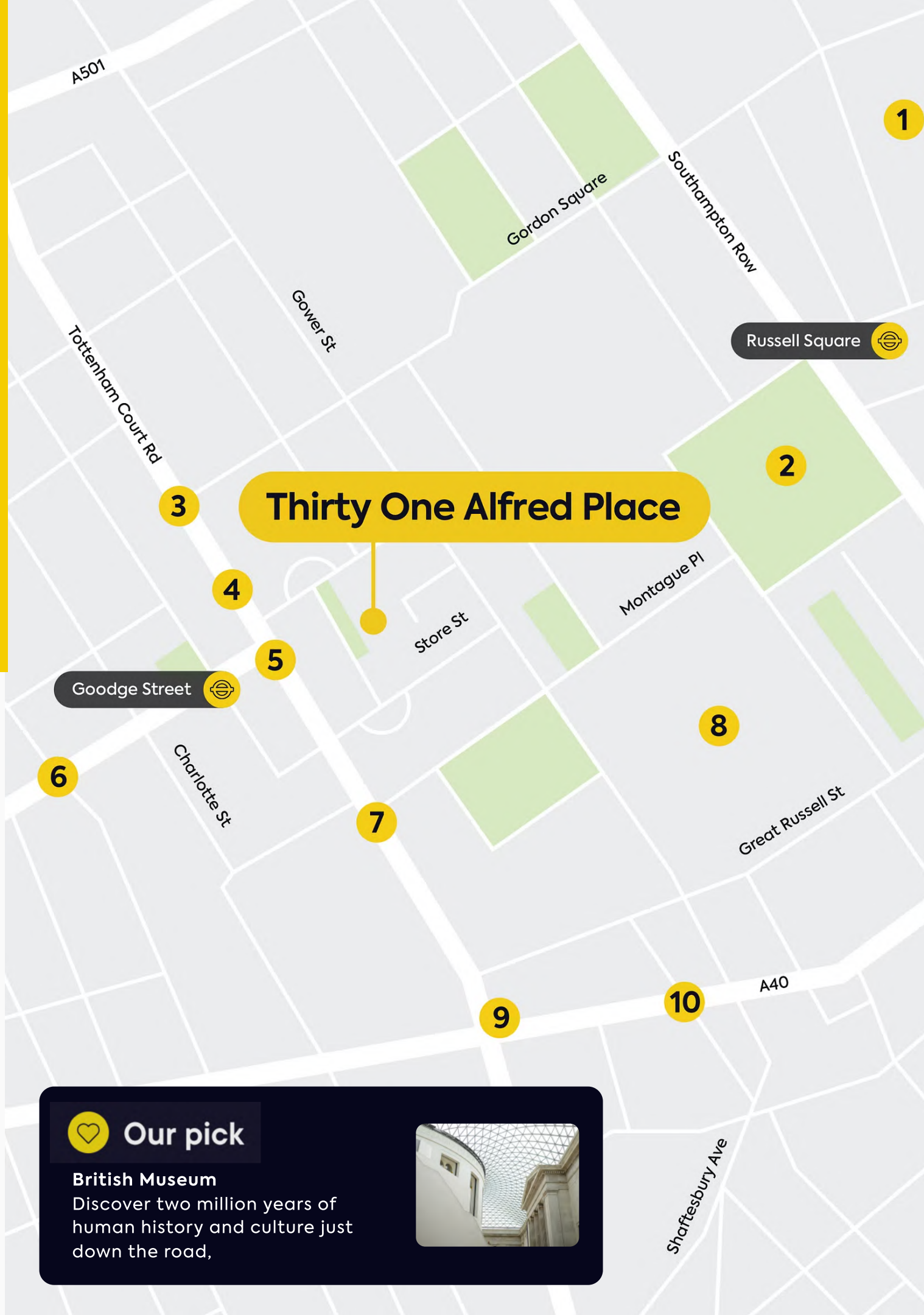

Things to do



From retail to fitness, cinema to culture, when you call Alfred Place home the surrounding area becomes your new playground.

There's no end to how you can spend your downtime, and the best of which is all within a 10-minute walk.

On your doorstep

Within

10

minutes



Highlights

- 1 Honey & Co. Daily
- 2 Treadwell's Books
- 3 Orchidya
- 4 Malet Street Gardens
- 5 L. Cornelissen & Son



Our pick

Honey & Co. Daily

A new deli, bakery & café, now open on Store Street, serving sandwiches, cakes and coffees.

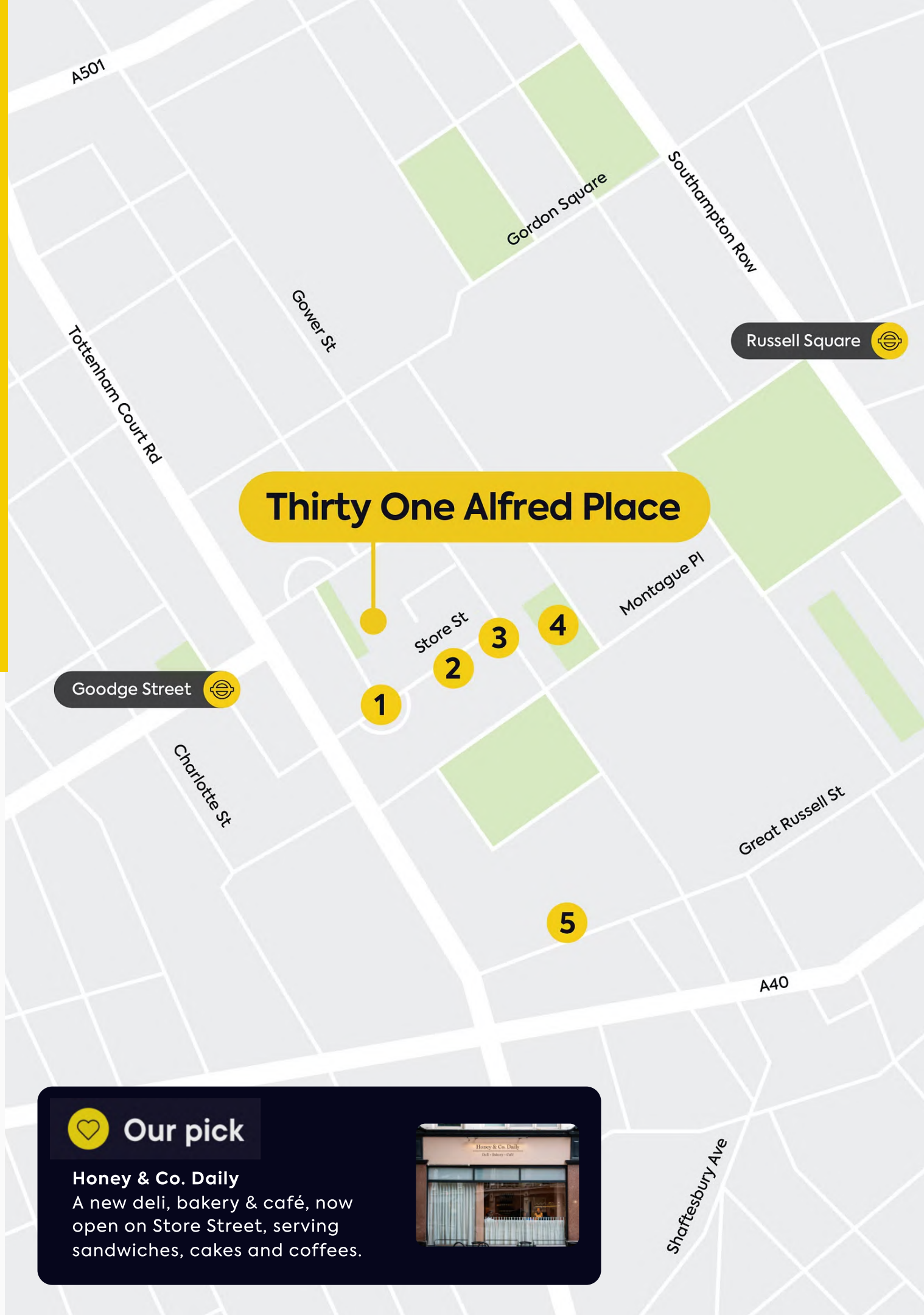

Hidden Gems



Alfred Place occupies a dream location, which offers the perfect mix of the bustling and the tranquil.

Getting to know the local area is a joy, as you uncover the surprises and treasures just waiting to be found.

Food & Drink

Things to do

Hidden Gems

Get in touch

We hope we've piqued your interest, but it's only just the beginning.
We'd love to show you more. Get in touch to book your viewing today.



Molly Maguire
+44 (0) 7887 841 816
molly.maguire@gpe.co.uk

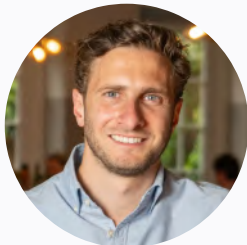

David Korman
+44 (0) 7435 939 956
david.korman@gpe.co.uk



Anna Tweed
+44 (0) 7990 633 486
anna.tweed@gpe.co.uk

[See Availability](#)



Dan Brown
+44 (0) 7710 249 297
dan.brown@workthere.com



Jodie Burwood
+44 (0) 7939 890 689
jodie.burwood@workthere.com

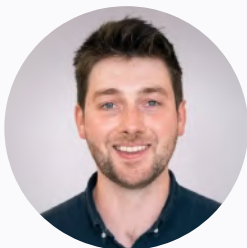

Tom Leahy
+44 (0) 7955 147 734
tom.leahy@workthere.com



Ben Orchard-Smith
+44 (0) 7557 988 115
ben@kontor.com



Luke Parkinson
+44 (0) 746 4715 644
luke.parkinson@kontor.com



Andrew Gibson
+44 (0) 7866 602 381
andrew@kontor.com

All CGIs are for indicative purposes only. Misrepresentation ACT 1967: Whilst all the information in these particulars is believed to be correct, agent nor Knighton Estates Ltd guarantee its accuracy nor is it intended to form any part of any contract. All areas quoted are approximate.